



**PRODUCT BROCHURE**



**PROJECT:** Syracuse High School **LOCATION:** Syracuse, UT **PANEL PROFILE:** 7.2 Panel & Artisan® Series **COLOR:** Silver Metallic & Black Metallic

# Contents

<b>4</b>	Product Application Chart & Index
<b>6</b>	Standing Seam Metal Roofing
<b>10</b>	Concealed Fastening Systems
<b>13</b>	Underhung Canopies
<b>14</b>	Soffits
<b>15</b>	Exposed Fastening Systems
<b>18</b>	Insulated Metal Panels
<b>19</b>	Structural Systems
<b>20</b>	Retrofit Solutions
<b>22</b>	Service That Makes a Difference

Cover Photo

**PROJECT:** *New Hampshire Technical Institute Student Center* **LOCATION:** *Concord, NH* **PANEL PROFILE:** *PBC* **COLOR:** *Galvalume®*

# Product Application Chart & Index

	STANDING SEAM ROOF	CONCEALED FASTENER SYSTEM	EXPOSED FASTENER SYSTEM	ROOF SYSTEM	EXTERIOR WALL	INTERIOR WALL LINER	UNDERHUNG/CANOPY	SOFFIT	FRAMING SYSTEM	PAGE NUMBER
LOKSEAM	■	■		■						7
SUPERLOK	■	■		■						7
BATTENLOK HS	■	■		■						8
ULTRA-DEK	■	■		■						9
DOUBLE-LOK	■	■		■						9
CRAFTSMAN		■		■						11
DESIGNER SERIES		■			■					11
MASTERLINE 16		■			■					12
SHADOWRIB		■			■					12
NUWALL		■			■					12
FW-120		■			■	■	■	■		12
CLASSIC		■				■	■			13
QWIKLOK		■				■	■			13
ARTISAN		■			■	■	■			14
FLEXLOC		■				■	■			14
7.2 PANEL			■	■	■					16
PBR			■	■	■					16
PBC			■	■	■					16
PBD			■	■	■					16
PBU			■	■	■					17
AVP			■		■					17
INSULATED METAL PANELS										18
LITEFRAME								■		19
NUROOF								■		21

*MBCI has earned its reputation as one of the nation's leading suppliers of preformed metal for roofs, walls, mansards and soffits by providing the highest quality building components and service in the industry.*

Descriptions and specifications contained herein were in effect at the time this publication was approved for printing. In a continuing effort to refine and improve products, MBCI reserves the right to discontinue products at any time or change specifications and/or designs without incurring obligation. To ensure you have the latest information available, please inquire or visit our website at [mbci.com](http://mbci.com). Application details are for illustration purposes only and may not be appropriate for all environmental conditions, building designs or panel profiles. Projects should be designed to conform to applicable building codes, regulations and accepted industry practices. If there is a conflict between this manual and project erection drawings, the erection drawings will take precedence. MBCI's insulated metal panel product line is manufactured by Metl-Span®.

This Product Application Chart is for general reference only. Not all panels, gauges and widths should be used for these applications. Please call MBCI for the best product for your specific application.

# STIMULATE YOUR IMAGINATION

WITH MBCI'S BROAD SPECTRUM OF PANEL OFFERINGS, DESIGN OPPORTUNITIES ARE EXPONENTIAL. PRODUCT OFFERINGS RANGING FROM SINGLE SKIN ROOF AND WALL PANELS TO INSULATED METAL PANELS, SOLUTIONS FOR NEW AND RETROFIT CONSTRUCTION, COATINGS IN A BREADTH OF COLORS AND APPLIED FINISHES PROVIDE YOU INSPIRATION TO **DESIGN YOUR MASTERPIECE.**

## THE MBCI ADVANTAGE

Since 1976, MBCI has been dedicated to providing our customers with the highest quality products and excellent service from our skilled professionals. MBCI is the industry-leading manufacturer of metal roof and wall systems, supplying products to the architectural, institutional, commercial, industrial, residential and agricultural markets. MBCI has facilities positioned strategically throughout the United States to best serve our customers.

*The industry-leading manufacturer of metal roof and wall systems.*

STIMULATE YOUR IMAGINATION  
STIMULATE YOUR IMAGINATION

PROJECT: Archer Government Complex LOCATION: Cheyenne, WY PANEL PROFILE: SuperLok® & Artisan® Series COLOR: Slate Gray



# STANDING SEAM METAL ROOFING

When your design requires a roofing system that is both aesthetically pleasing and structurally sound, choose one of MBCI's standing seam metal roof (SSR) systems. Our SSR systems are some of the most durable and weathertight roof systems available in the industry, providing longevity while enhancing the appearance of the building.

MBCI offers two types of standing seam metal roofs: vertical leg structural and trapezoidal structural. Each system carries the Underwriters Laboratories Wind Uplift (UL 90), Fire Resistance and Impact Resistance ratings covering a wide range of roof designs. Additional ratings have been given to the individual panel systems. Special clips are available for thermal roof expansion and contraction during extreme temperature changes. All trim is both weathertight and aesthetically pleasing, giving the roof a clean, finished appearance.

**PROJECT:** Conroe Fire Station No. 4 **LOCATION:** Conroe, TX **PANEL PROFILE:** BattenLok® HS **COLOR:** Tundra

# Vertical Leg Structural Standing Seam Metal Roof Systems

The vertical leg systems blend the aesthetics of an architectural panel with the strength of a structural panel. These panels have earned several UL uplift ratings, assuring reliability of performance, while also providing flexibility to meet design challenges.

Each of these SSR systems is designed to be installed over open framing. However, the MBCI LiteFrame®, 5/8" plywood or a composite roof assembly may be used as an alternate substructure.

**PROJECT:** Audubon National Wildlife Refuge **LOCATION:** Coal Harbor, ND **PANEL PROFILE:** BattenLok® HS **COLOR:** Classic Green



## LOKSEAM®

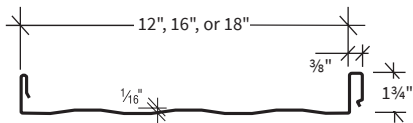
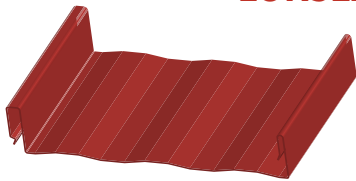

LokSeam® is a snap-together standing seam roof system with a 1 3/4" tall vertical rib for use on roofs with a minimum slope of 3:12. Available in 12-inch, 16-inch and 18-inch widths, LokSeam® panels can be installed over open framing or a solid substructure and are capable of transitioning from roof to fascia with the use of a rib cover. LokSeam® does not require a solid substructure for support.

### Product Specifications

- **Application:** Roof
- **Coverage Widths:** 12", 16", 18"
- **Minimum Slope:** 3:12
- **Panel Attachment:** Concealed Fastening System, Standard and UL 90 Clips
- **Gauges:** 24 (standard); 22 (12", 16", 18"), 26 (12") (optional)
- **Finishes:** Striated (standard); Embossed Striated (optional)
- **Coatings:** Galvalume Plus®, Signature® 200, Signature® 300, Signature® 300 Metallic

## SUPERLOK®

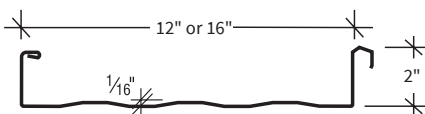
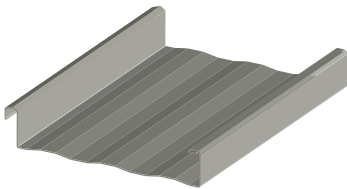

SuperLok® is a mechanically field-seamed system that combines a 2" tall slim rib with exceptional uplift resistance. MBCI designed the SuperLok® system to withstand the most rigorous weather conditions. This panel can be installed directly over purlins or bar joists, and does not require a solid substructure for support.

In addition to the UL 90 rating, the SuperLok® system meets a variety of ratings as tested under FM Global Corporation Standard 4471.

### Product Specifications

- **Application:** Roof
- **Coverage Widths:** 12", 16"
- **Minimum Slope:** 1/2:12
- **Panel Attachment:** Concealed Fastening System, Low, High (fixed or floating)
- **Gauges:** 24 (standard); 22, 26 (optional)
- **Finishes:** Striated (standard); Embossed Striated (optional)
- **Coatings:** Galvalume Plus®, Signature® 200, Signature® 300, Signature® 300 Metallic



**PROJECT:** Owens Community College **LOCATION:** Fredericktown, OH **PANEL PROFILE:** Curved BattenLok® **COLOR:** Colonial Red

## BATTENLOK® HS

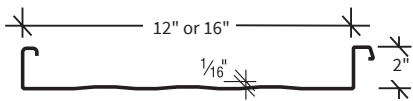
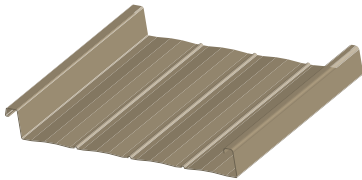

BattenLok® HS is a mechanically field-seamed, high strength structural standing seam roof system. The BattenLok® HS panels have a two-inch tall vertical seam and are available in both 12-inch and 16-inch widths. BattenLok® HS can be installed directly over purlins or bar joists and is capable of transitioning from roof to fascia. BattenLok® HS does not require a solid substructure for support.

Available in a profile suitable for curving in the field or through a third-party vendor contracted by the customer. Please contact a sales representative for order assistance.

### Product Specifications

- **Application:** Roof
- **Coverage Widths:** 12", 16"
- **Minimum Slope:** ½:12
- **Panel Attachment:** Concealed Fastening System, Low, High (fixed or floating), Utility (no insulation clearance)
- **Gauges:** 24 (standard); 22 (optional)
- **Finishes:** Smooth or Embossed; with Striations or Striations with Pencil Ribs (16" only)
- **Coatings:** Galvalume Plus®, Signature® 200, Signature® 300, Signature® 300 Metallic



# Trapezoidal Standing Seam Metal Roof Systems

The trapezoidal SSR systems are designed for strength, durability and weatherability. The standing seams are 3" above the lowest part of the panel, well above the water level as it flows off the roof. The rake/gable at both ends of each roof system eliminates the necessity of finishing in the low, flat part of the panel where the greatest possibilities for leaks occur in many other systems.

The trapezoidal SSR systems can be installed before or after the exterior walls are in place. All trim is attached after the roof is installed. With a recommended minimum slope of 1/4:12, these systems can be used on all types of construction, including metal, masonry or wood for either new or retrofit construction.

**PROJECT:** UDOT Strawberry Maintenance Station **LOCATION:** West Valley, UT **PANEL PROFILE:** Double-Lok® & Artisan® Series **COLOR:** Champagne Metallic



## ULTRA-DEK®

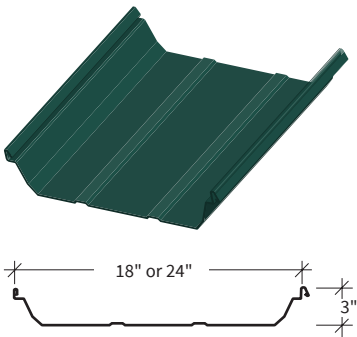

The Ultra-Dek® roof panel is a snap-together, trapezoidal leg standing seam roof system. Ultra-Dek® panels are available in 18-inch and 24-inch widths. Ultra-Dek® requires a minimum slope of 1/4:12 and is ideal for industrial, commercial and architectural applications. Ultra-Dek® can be erected on various types of construction.

### Product Specifications

- **Application:** Roof
- **Coverage Widths:** 18", 24"
- **Minimum Slope:** 1/4:12
- **Panel Attachment:** Concealed Fastening System, Low, High (fixed or sliding)
- **Gauges:** 24 (standard); 22 (optional)
- **Finishes:** Smooth (standard); Embossed (optional)
- **Coatings:** Galvalume Plus®, Signature® 200, Signature® 300, Signature® 300 Metallic

## DOUBLE-LOK®

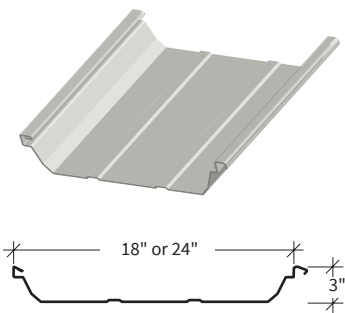

The Double-Lok® roof panel is a mechanically field-seamed, trapezoidal leg standing seam roof system. Double-Lok® panels are available in 18-inch and 24-inch widths and require a minimum slope of 1/4:12. Double-Lok® panels are ideal for industrial, commercial and architectural applications.

### Product Specifications

- **Application:** Roof
- **Coverage Widths:** 18", 24"
- **Minimum Slope:** 1/4:12
- **Panel Attachment:** Concealed Fastening System, Low, High, Fixed and Sliding and a 2" Stand off Clip
- **Gauges:** 22, 24
- **Finishes:** Smooth (standard); Embossed (optional)
- **Coatings:** Galvalume Plus®, Signature® 200, Signature® 300, Signature® 300 Metallic

# CONCEALED FASTENING SYSTEMS



**PROJECT:** *Washington County Coroner's Office* **LOCATION:** *Fayetteville, AR* **PANEL PROFILE:** *Craftsman™ Series, Artisan® Series & PBC*  
**COLOR:** *Galvalume® & Charcoal Gray*



## CRAFTSMAN™ SERIES

The Craftsman™ Series is a snap-on batten roof system, available in small and high profiles: small (SB) and high batten (HB).

The Craftsman™ Series is a water-shedding system and can be used for roofs and fascias only when installed over a water-proofed solid substructure with a minimum roof slope of 3:12. The Craftsman™ Series design makes complicated building transitions simple without the necessity of flashings. Slope changes from roof to fascia to soffit can be made with one continuous pan and batten.

Available in a profile suitable for curving in the field or through a third-party vendor contracted by the customer. Please contact a sales representative for order assistance.

### Product Specifications

- **Application:** Roof, Fascia
- **Coverage Widths:** 12", 16½"
- **Minimum Slope:** 3:12
- **Panel Attachment:** Concealed Fastening System
- **Gauges:** 24 (standard); 22, 26 (optional)
- **Finishes:** Smooth (standard); Striated (optional)
- **Coatings:** Galvalume Plus®, Signature® 200, Signature® 300, Signature® 300 Metallic

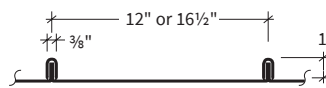
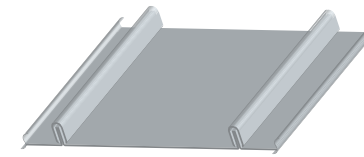

SB-12

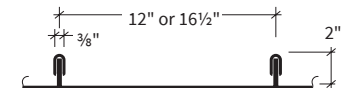
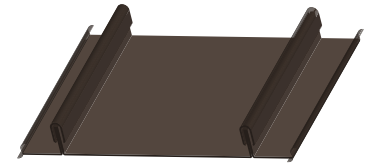

HB-12

## DESIGNER™ SERIES

The Designer™ Series panel provides the toughness of metal while creating an attractive, flexible and functional wall or fascia panel.

The Designer™ Series Fluted Panel offers a continuous rib design with a hidden sidelap where the panels join together. Ribs are 4 inches wide and 3/8 inch deep, providing interesting shadow lines along the length of the wall. The panel legs are 1 3/4 inch deep, allowing ample space for rigid board, blanket or batt insulation in the cavity. The panel features concealed fastened systems enhancing the appearance.

### Product Specifications

- **Application:** Wall
- **Coverage Widths:** 16" (fluted)
- **Panel Attachment:** Concealed Fastening System
- **Gauges:** 24 (standard); 22 (optional)
- **Finishes:** Smooth (standard); Embossed (optional)
- **Coatings:** Galvalume Plus®, Signature® 200, Signature® 300, Signature® 300 Metallic

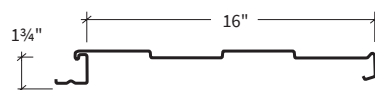
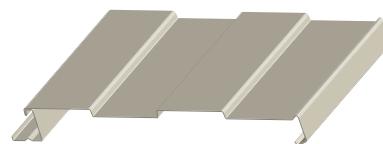

## MASTERLINE 16

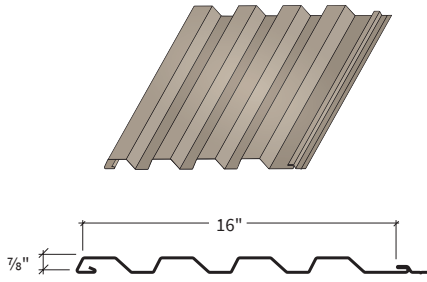

MasterLine 16 is a concealed-fastener metal wall panel that provides an interesting shadow line, enhancing the aesthetics of the panel. While primarily designed for horizontal applications, it can also be installed vertically to give a distinguished architectural design. The panels provide 16-inch coverage and are available with factory-applied mastic in the side laps. Panels may be attached to metal studs, with or without sheathing, as well as to subgirts.

### Product Specifications

- **Application:** Wall
- **Coverage Width:** 16"
- **Panel Attachment:** Concealed Fastening System
- **Gauges:** 24 (standard); 22 (optional)
- **Finishes:** Smooth (standard); Embossed (optional; 24 and 22 gauge only)
- **Coatings:** Galvalume Plus®, Signature® 200, Signature® 300, Signature® 300 Metallic

## SHADOWRIB™

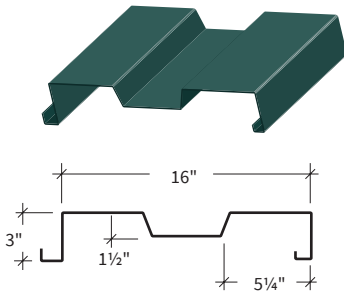

ShadowRib™ is a three-inch deep panel that combines aesthetics, economy and function to bring definition to metal structures. ShadowRib™ is a proven performer and a versatile tool to the designer. Structural strength in the ShadowRib™ panel is accomplished without sacrificing appearance or design flexibility. The fluted face creates distinctive shadow lines.

### Product Specifications

- **Application:** Wall
- **Coverage Width:** 16"
- **Panel Attachment:** Concealed Fastening System (inside); ShadowRib™ Panel Clip (outside)
- **Gauges:** 24 (standard); 22 (optional)
- **Finishes:** Smooth (standard); Embossed (optional)
- **Coatings:** Galvalume Plus®, Signature® 200, Signature® 300, Signature® 300 Metallic

## NUWALL®

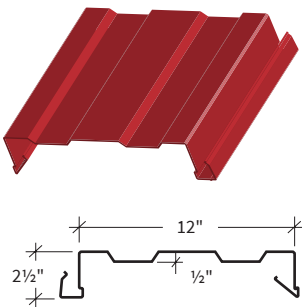

The NuWall® wall panel can be used for either new or retrofit construction. This concealed-fastened system creates a clean, uninterrupted wall on a building.

### Product Specifications

- **Application:** Wall
- **Coverage Width:** 12"
- **Panel Attachment:** Concealed Fastening System
- **Gauges:** 24 (standard); 22 (optional)
- **Finishes:** Smooth (standard); Embossed (optional)
- **Coatings:** Galvalume Plus®, Signature® 200, Signature® 300, Signature® 300 Metallic

## FW-120

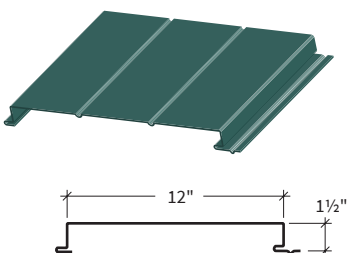

The FW-120 panel is a concealed-fastened wall and liner panel that provides a flat appearance. FW-120 is commonly used for architectural, commercial and industrial markets. The heavy gauge offering provides for large spanning capabilities, particularly in composite wall applications.

### Product Specifications

- **Application:** Wall, Fascia
- **Coverage Width:** 12"
- **Panel Attachment:** Concealed Fastening System by use of FW-120 Clip
- **Gauges:** 24 (standard); 22, 20 (optional)  
FW-120 Clip not available for 20-gauge panels
- **Finishes:** Smooth (standard); Embossed (optional)
- **Coating:** Signature® 300

# UNDERHUNG CANOPIES

MBCI offers two separate panel profiles for underhung canopies, the Classic® Series and QwikLok™.



PROJECT: *Texaco Service Station* LOCATION: *Beaumont, TX* PANEL PROFILE: *QwikLok™* COLOR: *White*

## CLASSIC® SERIES

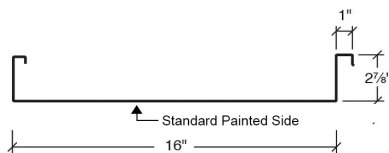
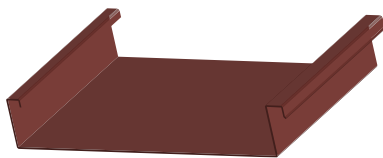

The Classic® Series is a time-tested performer. Through the years, this versatile and valuable panel has been used for canopies, walkway covers and soffits. The Classic® Series creates a clean, flush appearance when used as a canopy system. The standard Classic® Series panel is painted on the bottom side. Please specify if the panel should be painted on the top side. The standard Classic® Series panel is painted on the bottom side. Please specify if the panel should be painted on the top side.

### Product Specifications

- **Applications:** Canopies, Walkway Covers and Soffits
- **Coverage Widths:** 16"
- **Panel Attachment:** Concealed Fastening System
- **Gauges:** 24 (standard); 22 (optional)
- **Finishes:** Smooth (standard); Embossed (optional)
- **Coatings:** Galvalume Plus®, Signature® 200, Signature® 300, Signature® 300 Metallic

## QWIKLOK™

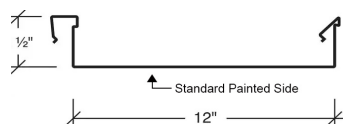
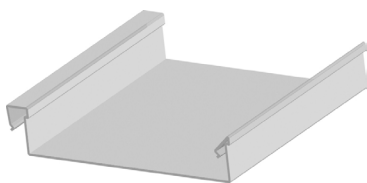

QwikLok™ panels are ideal for underhung applications; no more fighting with trying to install two panels at one time. Unlike conventional roofing cover, QwikLok™ panels can be assembled from the underside of the structure one panel at a time, producing a flush appearance with no exposed fasteners. The standard QwikLok™ panel is painted on the bottom side. Please specify if the panel should be painted on the top side.

### Product Specifications

- **Applications:** Canopies, Walkway Covers and Soffits
- **Coverage Width:** 12"
- **Panel Attachment:** Concealed Fastening System
- **Gauge:** 24
- **Finishes:** Smooth (standard); Embossed (optional)
- **Coating:** High Gloss White

# SOFFITS

MBCI offers two separate panel profiles to be used as soffits. The Artisan® Series is simplistic and offers uniform dimensions and a clean appearance. The FlexLoc® panel system combines a clean, flat appearance with an easy-to-engage seam.



**PROJECT:** Champions Academy and Childcare **LOCATION:** Cypress, TX **PANEL PROFILE:** Artisan® Series **COLOR:** Burnished Slate

## ARTISAN® SERIES

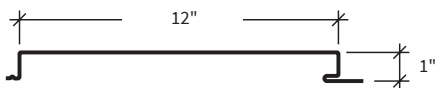
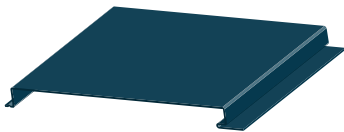

The simplicity of the Artisan® Series panel is its best design feature. Uniform dimensions and a clean appearance allow the designer to plan modules, eliminate complicated pieces and follow wall curvatures. The Artisan® panel can be vertical, horizontal, perpendicular or skewed to the building line, allowing the designer multidimensional freedom to create.

### Product Specifications

- **Applications:** Soffits and Interior Liners
- **Coverage Widths:** 12"
- **Panel Attachment:** Concealed Fastening System
- **Gauges:** 24 (standard); 26, 22 (optional)
- **Finishes:** Smooth (standard); Embossed (optional)
- **Coatings:** Galvalume Plus®, Signature® 200, Signature® 300, Signature® 300 Metallic

## FLEXLOC®

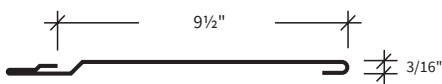
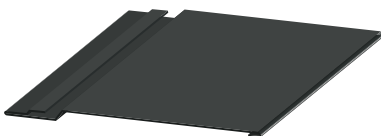

Available in 9½-inch widths, the FlexLoc® panel is clipped down to a waterproofed solid substrate when used in roof applications.

### Product Specifications

- **Applications:** Soffits and Curved Applications
- **Coverage Widths:** 9½"
- **Panel Attachment:** Concealed Fastening System
- **Gauges:** 24 (standard); 22 (optional)
- **Finishes:** Smooth (standard); Embossed (optional)
- **Coatings:** Galvalume Plus®, Signature® 200, Signature® 300, Signature® 300 Metallic



# EXPOSED FASTENING SYSTEMS

MBCI exposed fastening systems help provide contemporary and environmentally-friendly aesthetics. Oftentimes these panels can be installed both vertically and horizontally, giving you numerous options for your design. To see all of our exposed-fastening options, visit us online at [mbci.com](http://mbci.com) or [shop.mbc.com](http://shop.mbc.com).

## 7.2 PANEL

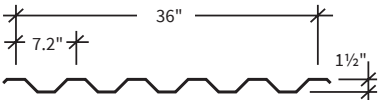
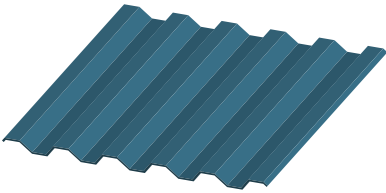

When your design calls for a commercial or industrial exposed fastener panel, the 7.2 Panel is an ideal choice. This panel offers versatility and functionality for roofs and walls. The symmetrical rib 7.2 Panel offers excellent spanning and cantilever capabilities, making it an excellent choice for carports and walkway canopies. When used on walls, the 7.2 Panel is typically ordered as “reverse rolled” and can be installed either vertically or horizontally.

### Product Specifications

- **Applications:** Roof and Wall
- **Coverage Width:** 36"
- **Rib Spacing:** 7.2" on Center
- **Rib Height:** 1 1/2"
- **Minimum Slope:** 1/2:12
- **Panel Attachment:** Exposed Fastening System
- **Gauges:** 24 (standard); 26, 22 (optional)
- **Finishes:** Smooth (standard); Embossed (optional)
- **Coatings:** Galvalume Plus®, Signature® 200, Signature® 300, Signature® 300 Metallic

## PBR

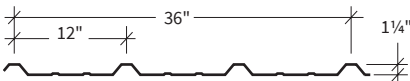
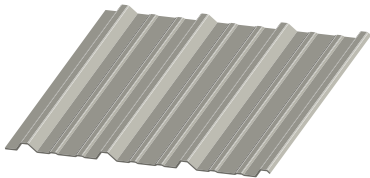

The PBR panel is commonly used for a wide variety of architectural, agricultural, commercial and industrial applications. PBR is a structural, exposed-fastened panel that can be used for both roof and wall applications. The minimum roof slope for PBR is 1/2:12.

### Product Specifications

- **Applications:** Roof and Wall
- **Coverage Width:** 36"
- **Rib Spacing:** 12" on Center
- **Rib Height:** 1 1/4"
- **Minimum Slope:** 1/2:12
- **Panel Attachment:** Exposed Fastening System
- **Gauges:** 26 (standard); 24, 22 (optional)
- **Finishes:** Smooth (standard); Embossed (optional)
- **Coatings:** Galvalume Plus®, Signature® 200, Signature® 300

## PBC

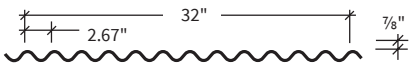
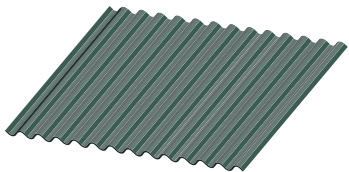

The PBC panels can be used for both roof and wall applications. PBC panels are attached to a building structure with exposed fasteners and is often used in horizontal applications on walls.

### Product Specifications

- **Applications:** Roof and Wall
- **Coverage Width:** 32"
- **Rib Spacing:** 2.67" on Center
- **Rib Height:** 7/8"
- **Minimum Slope:** 3:12
- **Panel Attachment:** Exposed Fastening System
- **Gauges:** 26 (standard); 24, 22 (optional)
- **Finishes:** Smooth (standard); Embossed (optional)
- **Coatings:** Galvalume Plus®, Signature® 200, Signature® 300

## PBD

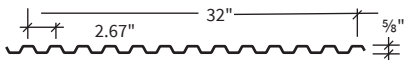

The PBD panel is an exposed-fastened panel system that can be used for roof and wall applications. When used in wall applications, panels can be installed vertically or horizontally. The ribs in the PBD panel are symmetrical from top to bottom, which makes this panel ideal as a roof liner.

### Product Specifications

- **Applications:** Roof and Wall
- **Coverage Width:** 32"
- **Rib Spacing:** 2.67" on Center
- **Rib Height:** 5/8"
- **Minimum Slope:** 3:12
- **Panel Attachment:** Exposed Fastening System
- **Gauges:** 26 (standard); 24, 22 (optional)
- **Finishes:** Smooth (standard); Embossed (optional)
- **Coatings:** Galvalume Plus®, Signature® 200, Signature® 300





**PROJECT:** Legacy Junior High School **LOCATION:** Layton, UT **PANEL PROFILE:** PBU & Artisan® Series **COLOR:** Laurel Green & Tundra

## PBU

The PBU panel is an exposed fastener system that can be used for both roof and wall applications and can be installed directly over purlins or joists. PBU offers the versatility of being used in both vertical and horizontal applications to give designers a contemporary appearance for their building project. PBU is recommended for 1:12 or greater roof slopes.

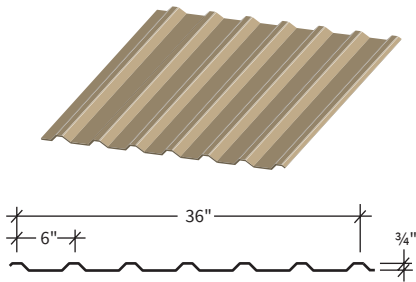

### Product Specifications

- **Applications:** Roof and Wall
- **Coverage Width:** 36"
- **Rib Spacing:** 6" on Center
- **Rib Height:** 3/4"
- **Minimum Slope:** 1:12

- **Panel Attachment:** Exposed Fastening System
- **Gauges:** 26 (standard); 24, 22 (optional)
- **Finishes:** Smooth (standard); Embossed (optional)
- **Coatings:** Galvalume Plus®, Signature® 200, Signature® 300

## AVP

The AVP panel is used for wall application and features pencil ribs, providing improved aesthetics to building design.

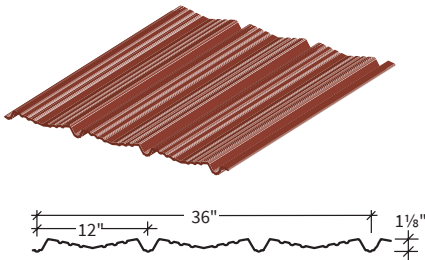

### Product Specifications

- **Application:** Wall
- **Coverage Width:** 36"
- **Rib Spacing:** 12" on Center
- **Rib Height:** 1 1/8"

- **Panel Attachment:** Exposed Fastening System
- **Gauges:** 26 (standard); 22, 24, 29 (optional)
- **Finishes:** Smooth (standard); Embossed (optional)
- **Coatings:** Galvalume Plus®, Signature® 200, Signature® 300



# ENERGY EFFICIENT AND BUILT TO LAST

Insulated Metal Panels, or IMPs, address the four critical performance barriers (water, air, vapor, thermal) in a single component consisting of metal skins and a foam insulating core. IMPs act simultaneously as the exterior facade, insulation and finished interior wall, offering the most advanced protection possible over the lifespan of a building. Whether your project requires unique aesthetic or performance considerations, or even fire-resistant capabilities, these panels offer the ultimate in design freedom and flexibility.

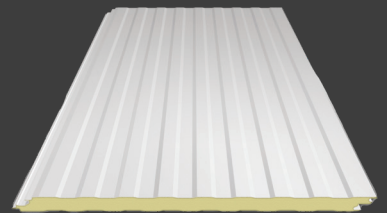

**PROJECT:** Fujisawa Healthcare Inc. **LOCATION:** Grand Island, NY **PANEL PROFILE:** CF Architectural/Horizontal **COLOR:** Silver Metallic

# STRUCTURAL SYSTEMS



## LITEFRAME®

Flexibility is the key to establishing discriminating profiles for mansard and fascia applications. Our LiteFrame® assortment gives the designer total control to create shapes that enhance a building's character. Virtually any combination of hat sections, channel sections and sub-girts can be made, allowing the designer to make a statement with stature and style.

This light-gauge structural framing was designed for preformed metal panels. MBCI precision roll forms LiteFrame® products in 20-foot lengths, but custom lengths are available. Hat sections and channel sections are easily assembled to make strong structural-type framing members.

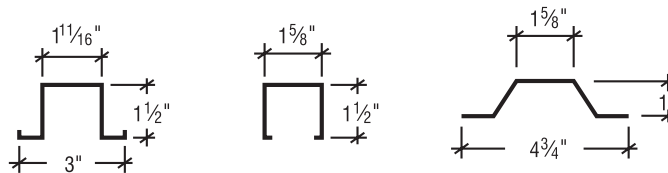

## STANDARD AND CUSTOM STRUCTURAL SHAPES

MBCI manufactures a complete line of structural shapes roll-formed to dimensions common to the metal building industry. Additionally, custom shapes can also be formed to accommodate specific project requirements.

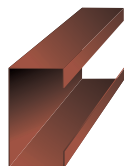

Cee Profile

### Cee Sections:

- Available in 4"-12" widths
- Webs with flanges in sizes 2", 2 1/2", 3", 3 1/2" & 4"
- 12, 14, 16 gauge



Zee Profile

### Zee Sections:

- Available in 3 1/2"-12" widths
- Webs with flanges in sizes 2 1/2" & 3 1/2"
- 12, 14, 16 gauge

**PROJECT:** Taylor Power Systems **LOCATION:** Richland, MS **PANEL PROFILE:** 7.2 Panel **COLOR:** Everglade & Silver Metallic



# RETROFIT SOLUTIONS

Whether your current roof is leaking, has problematic rainwater discharge, expensive maintenance costs, deficient energy efficiencies or all of these issues, MBCI's NuRoof® Retrofit System can help.



**BEFORE AFTER**

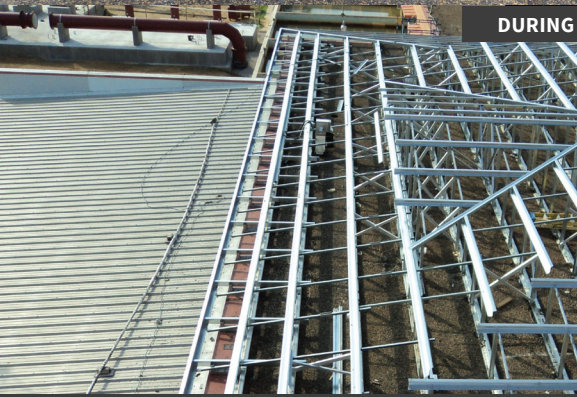

**DURING**

**PROJECT:** Dallas County Waste Water Treatment Facility **LOCATION:** Dallas, TX  
**PANEL PROFILE:** BattenLok® HS with a NuRoof® Retrofit System **COLOR:** Champagne Metallic

The NuRoof® framing system utilizes light-gauge (16 ga. to 12 ga.) steel framing installed directly over the existing roof's framing members to create a sloped plane. Regardless of whether your roof substrate is steel, wood or concrete, MBCI's NuRoof® system can be employed to satisfy the building owner's requirements. MBCI has the experience required to design a retrofit framing system that will comply with the original load requirements of the existing roof. The NuRoof® framing system has been designed to allow for a UL 90 rating using certain spacing requirements as well as meeting a variety of live and wind load requirements.

The existing roof's physical footprint, framing system and other rooftop conditions will most likely determine the new roof's geometry. A low-sloped application is typically driven by economy and designed to discharge rainwater from the roof. High-slope applications are designed to improve and update the look of an existing building in conjunction with improving the performance of the roof.

Once a NuRoof® framing system has been installed, one of MBCI's standing seam metal roofs is typically installed, creating a ventilated attic space while providing an architecturally appealing roof.

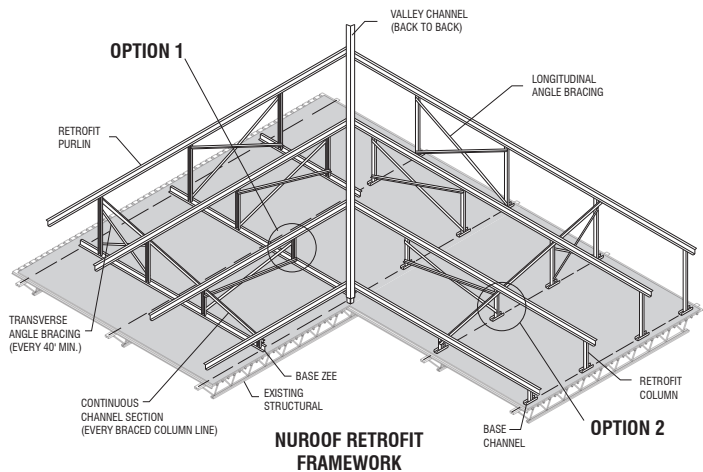
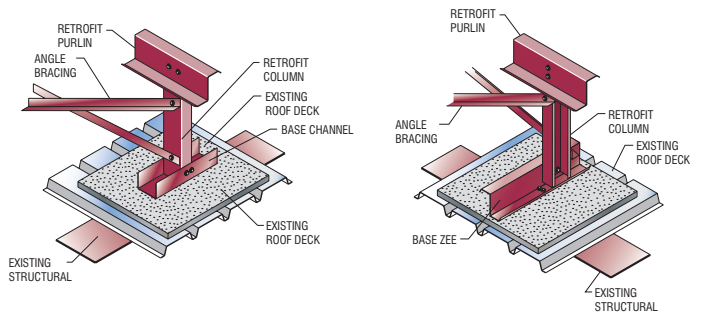



# SERVICE THAT MAKES A DIFFERENCE

MBCI was founded on its commitment to service. The additional effort from our staff sets MBCI apart from the competition. MBCI's Project Service team is staffed and prepared to provide professional assistance to the architectural and contracting communities. From the initial project concept, Project Services will assist in developing budget criteria and product selection as well as estimating and shop drawings.

  
**AIA  
CONTINUING  
EDUCATION**

MBCI's educated sales personnel are authorized to conduct AIA Continuing Education classes for the many courses we offer. Contact us by phone or through our website to schedule a meeting or lunch-and-learn today.

**CERTIFIED  
INSTALLER  
PROGRAM**

The MBCI Certified Installer courses cover every aspect of putting our sophisticated systems on your roof, from materials and handling, weathertightness and technical requirements to installation steps and specific detail conditions.

**SINGLE SOURCE™  
WARRANTY**

When you specify one of MBCI's Single Source™ Warranties, you can have confidence that your project will be covered by the most comprehensive warranty available. MBCI will conduct timely inspections to guarantee that the approved details are being used and the roof is being properly installed. Any discrepancies found during these inspections that would prevent issuance of the warranty will be quickly brought to the architect's attention. Should a leak occur after the warranty has been issued, the owner can rely on MBCI to handle.



**PROJECT:** Lester E. Palmer Events Center **LOCATION:** Austin, TX **PANEL PROFILE:** SuperLok® **COLOR:** Galvalume Plus®

## GREEN BUILDING BENEFITS

MBCI's metal panels are energy efficient, recyclable, durable, lightweight and cost-effective. Our panels are comprised of 25 percent to 35 percent recycled materials and our single skin panels are virtually 100 percent recyclable.

Cool metal roofing provides energy savings, offering both economical and environmental benefits. Our panels are Cool Roof compliant through the CRRC-1 Program and have reflectivity performance for roof pitches greater than 2:12.

Our insulated metal panels (IMPs) have high R-values, which provide superior thermal performance and reduced energy consumption, allowing for smaller greenhouse gas emissions and reduced energy costs for building owners. IMPs also mitigate thermal drift, which is common when using unfaced polyisocyanurate rigid board insulation.

IMPs qualify as continuous insulation (ci) where required by the International Energy Conservation Code® (IECC) and ASHRAE 90.1. This allows for insulation to be free from significant thermal bridging. And, because of their unique self-sealing side joints, IMPs also function as an important part of a Continuous Air Barrier (CAB) system.

## TRIM & FLASHING

All trim and flashing is available in the same gauge and finish as our panel offerings. A complete selection of standard trim and made-to-specification flashing in lengths up to 20 feet, three inches is available upon request. All flashing is designed to minimize exposed fasteners.

## TECHNICAL INFORMATION

MBCI conforms to industry-accepted metal and finish coating standards. Physical properties are available upon request. MBCI is committed to an aggressive, independent physical testing program to continually comply with guidelines on water penetration, uplift ratings and structural performance.

## MATERIALS & COATINGS

The base metal is 22-, 24- or 26-gauge steel manufactured from either high-strength Galvalume® produced to ASTM A792/A792M-AZ50 or AZ55, Grade 50 or HDG produced to ASTM A653/A653M-G90 structural aluminum. Finishes include baked enamel, urethane and Plastisol. All materials are available smooth or stucco-embossed.

All metal architectural panels have wide, flat surfaces to meet the demands of today's design. While MBCI has recognized and responded to this requirement, we have a responsibility to advise that a wide and perfectly flat appearance is not always possible. In some wide products, panel distortion—called oil canning—may occur and require additional aesthetic tolerance and/or additional support behind the panel face. Heavier gauges, narrower widths, striations and embossing minimize oil canning.

## PAINT FINISHES

MBCI offers one of the largest color selections in the industry. Each of our paint colors qualifies as a cool roof on sloped roofs above 2:12. Our applied finishes work as an excellent alternative to masonry or tilt-wall construction and are available on our insulated metal panels.

### **SIGNATURE® 300/SIGNATURE® 300 METALLIC**

This fluorocarbon paint system combines ceramic pigmentation with polyvinylidene fluoride (70 percent of resin solids) for a superior, long-lasting finish. Outstanding performance and durability are achieved through this proprietary resin technology. Signature® 300 is recognized as providing unsurpassed performance in critical areas such as color retention, film erosion rate and chemical resistance.

### **SIGNATURE® 200**

Signature® 200 is a thermoset coating system composed of polyester resin modified by copolymerization with a functional silicone resin intermediate. With high quality ceramic pigmentation, Signature® 200 offers optimum exterior protection plus superior resistance to chemical corrosion and ultraviolet radiation. Signature® 200 represents the most sophisticated silicone polyester coating system in the industry.

## PAINT WARRANTIES

Forty-year limited paint warranties are available upon written request and project qualification for most paint colors. For details and color exceptions, please review the Paint Warranty documents available at [MBCI.com](http://MBCI.com). (Outside the continental United States, please inquire.)



Descriptions and specifications contained herein were in effect at the time this publication was approved for printing. In a continuing effort to refine and improve products, MBCI reserves the right to discontinue products at any time or change specifications and/or designs without incurring obligation. To ensure you have the latest information available, please inquire or visit our website at [mbci.com](http://mbci.com). Application details are for illustration purposes only and may not be appropriate for all environmental conditions, building designs or panel profiles. Projects should be designed to conform to applicable building codes, regulations and accepted industry practices. If there is a conflict between this manual and project erection drawings, the erection drawings will take precedence. MBCI's insulated metal panel product line is manufactured by Metl-Span®.

© 2023 MBCI, part of **Cornerstone Building Brands**, Inc. ALL RIGHTS RESERVED. 0705209991131/RevB/MS/1123

[mbci.com](http://mbci.com) | [shop.mbcicom](http://shop.mbcicom)