



Installation Guide

VERSA &
METAL BLOCK



MAC
METAL ARCHITECTURAL
PUSHING
THE
ENVELOPE



ATTENTION

PROTECTION

The material may contain sharp edges. For this reason, we recommend that you wear the appropriate protective equipment: safety harness, safety boots, hard hat, safety glasses, and gloves.



WARRANTY

FOR THE WARRANTY TO BE APPLICABLE, INSTALLATION MUST BE CARRIED OUT IN ACCORDANCE WITH THE STANDARDS SET OUT IN THE UPDATED BUILDING CODE, ALONG WITH THE MANUFACTURER'S RECOMMENDATIONS.

If a problem arises during profile installation, it is important to notify the distributor agent before installing 5 sheets to ensure that the warranty applies, and also to ensure that there are no corrections to be made to the installation surface.

HANDLING

Handle sheets with care. Always lift sheets vertically, not horizontally, to prevent them from bending or warping. Two or more people are recommended, depending on length.

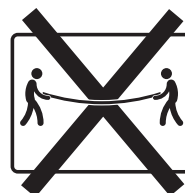

PACKAGING HANDLING

To limit the risk of material breakage, it is important to follow certain rules when when handling packaging:

1. Keep movement of materials to a minimum before installation.
2. Always take particular care when transporting panels from one point to avoid bending the panels.
3. Use a forklift with forks adjusted to maximum width to handle panel packs of up to 20 ft.
4. Beyond this length, use a fork-lift truck with boom and loading bar, or a crane.



HANDLING PACKAGES
OF UP TO
MAXIMUM OF 20 FT



HANDLING PACKAGES
OF 20 FT AND OVER

ORDER INTAKE & INSPECTION

It is the customer's responsibility to inspect the order upon receipt. In the event of an error or damage to a panel, it is important to notify the distributor as soon as possible so that the situation can be rectified.

STORAGE

To preserve the aesthetic and physical properties of MAC Metal Architectural Versa & Metal Block profiles, it is important to observe certain storage rules.

If panels cannot be installed immediately after delivery, store them indoors in a dry place, on a flat, well-ventilated surface. Keep movement to a minimum to minimize the risk of breakage.

Outdoor storage is the customer's responsibility. If outdoor storage is absolutely necessary, place the panels flat in a location that is not directly exposed to sunlight or extreme temperatures. These factors can cause the protective film to adhere more tightly to the panels, making it difficult to remove and leaving traces of adhesive on the surface of the product when removed. In addition, the accumulation of stagnant water on packaging can contribute to its deterioration, so it's vital to protect your order.

It is important to follow these recommendations:

1. If possible, choose a level, out-of-the-way location where the panels will not interfere with work on the site, and with limited exposure to the sun.
2. Cover the floor with plastic sheeting to prevent moisture from the ground from reaching the panels.
3. Place panels approx. 6 in (152 mm) from the floor to allow air circulation.
4. Raise part of the panels to allow rainwater to run off.
5. Protect the panels with a cloth. Do not use plastic, as this can lead to condensation.

ZIP SYSTEM, INSULATED R-SHEATHING PANELS

Installation of MAC coatings on Zip System, Insulated R Sheathing or similar dual-composition panels comprising a softer-than-wood compound is not recommended.

This type of panel does not provide a rigid installation base for MAC products and allows warping when exposed to sunlight depending on temperature, which then results in warping of the cladding panels.

1. TOOLS

To get the job done right, you'll need a bending machine or bending pliers, a screwdriver and sheet-metal chisel, sealant, MAC Cutter specialized for Versa & Metal Block profiles, metal blade (see recommendations), electric scissors and a MAC bending bar. You'll also need a level and a tape measure.

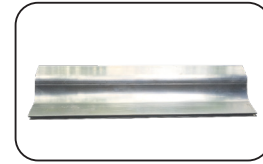
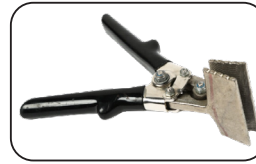
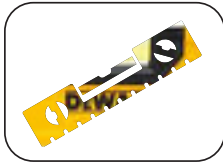

ROTATING SAW

Cold-cutting rotary saws must be used with a specialized metal blade and in accordance with the manufacturer's recommendations. Please refer to the cutting guide available on our website for details of use.

1.1 ACCESSORIES

Here is a list of accessories for installing and finishing roof profiles:

- MAC wood or metal screws, depending on project type
- High-temperature sealing membrane
- Self-adhesive elastomeric membrane
- Steel roll
- Moldings
- Sealant

1.2 MAC SCREW TYPES

The use of MAC screws is highly recommended. In addition to being perfectly adapted to our profiles, they are duly tested and comply with ASTM B-117 2000h.

Should any other screw be used, it must comply with ASTM B-117 2000h to support the product's 40-year warranty.

Screw in with moderate contact so as not to interfere with material expansion. Screws must not exert upward or downward pressure to avoid rounding the material.



K-LATCH MAC Self
Drilling screw A053.250



K-LATCH MAC
Wood Screw A058.250

Versa & Metal Block moldings & flashing

No. M10G
Starter strip

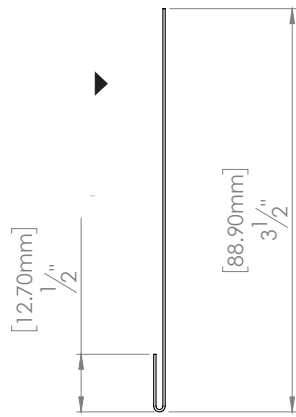

No. M50G
Drip flashing

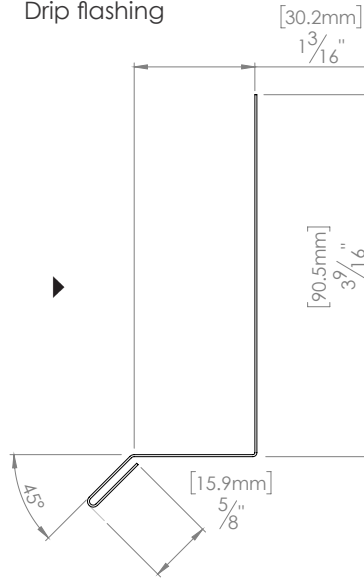

No. M14G
L Trim

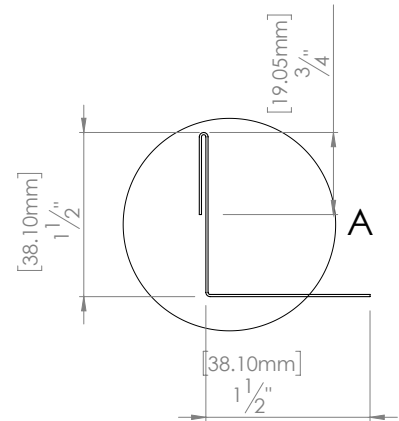

No. M56G
Extended drip flashing w/ variable

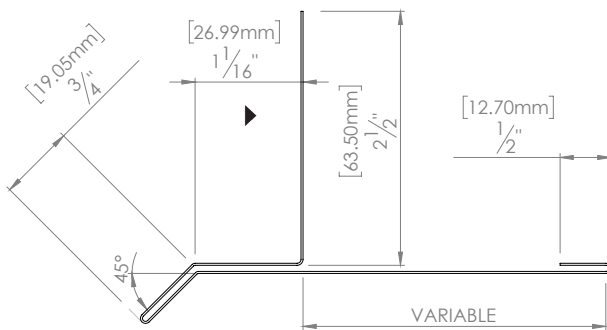

No. M22G
Inside corner

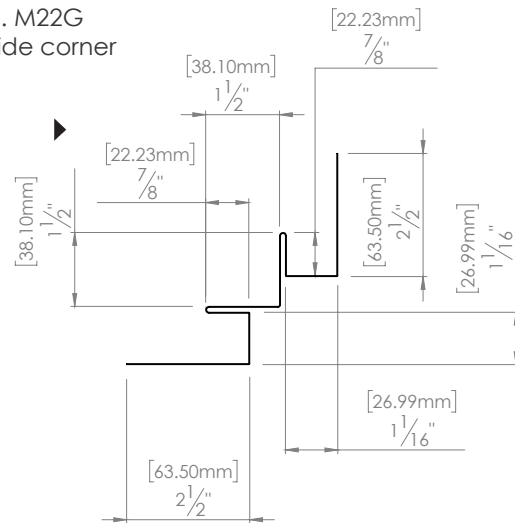

No. M01G
J Trim

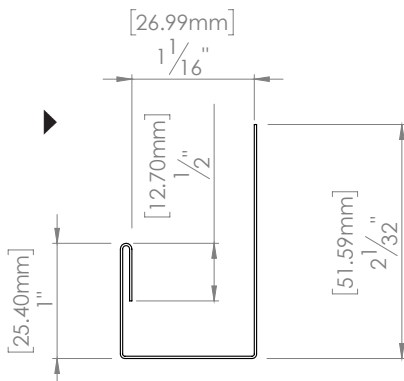

Versa & Metal Block moldings & flashing

No. M20G

Outside corner (2 pieces)

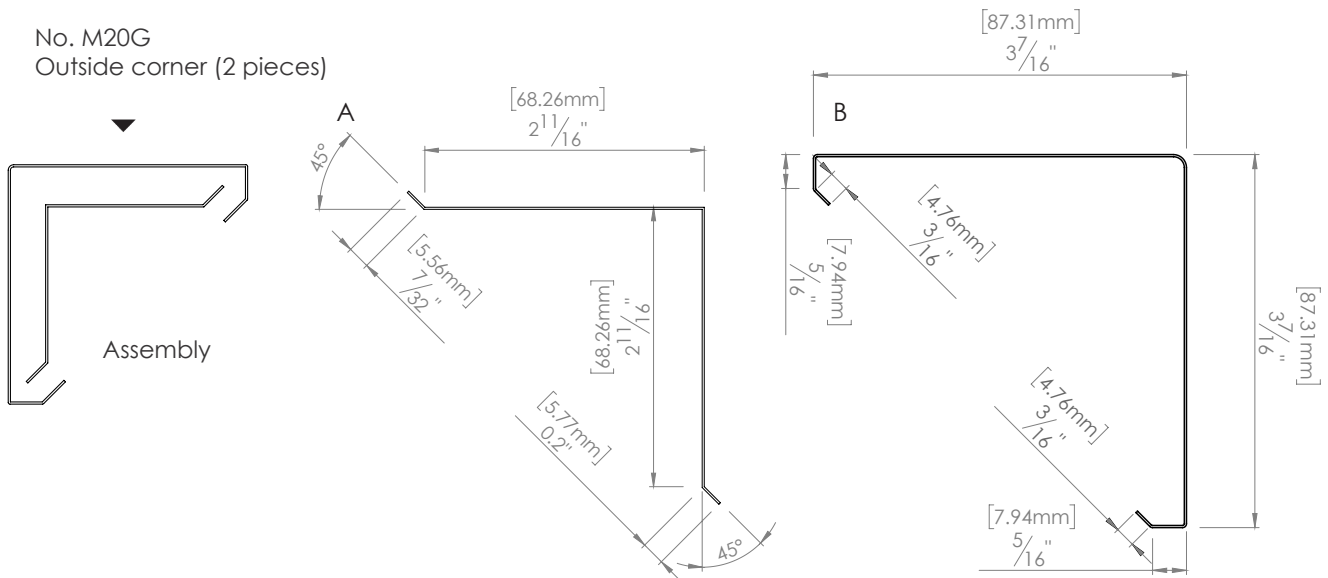

2. INSTALLATION RECOMMENDATIONS

This installation guide provides general guidelines for the installation of MAC Metal Architectural's non-recessed screw siding profile. Siding installation should always be performed by a steel siding installation specialist. The information contained in this guide is for informational purposes only and may not be suitable for all building types and/or climatic conditions. The examples given are valid at the time of publication. At all times, please refer to and comply with local building codes and regulations.

MAC Metal Architectural reserves the right to modify the content of this guide at any time, without prior notice. To ensure you always have the most up-to-date information, please consult our website or contact your representative.

INSULATION & VENTILATION

When designing the building, make sure that all components are properly installed, including the ventilation system needed to prevent condensation. Condensation can occur in all types of buildings, and is therefore not unique to buildings made with metal profiles. Poor ventilation can lead to moisture problems and reduced insulation efficiency.

To ensure that the best practices are used for your project, refer to a building insulation and ventilation professional. They'll be able to guide and advise you properly.

VERSA PROFILE

The Versa available in 12 in (305 mm) x 1 in (25.4 mm) x custom length according to plans and specifications. It stands out for its ability to create large, smooth surfaces.



VERSA- 12 in (305 mm) x 1 in (25.4 mm) x custom length

METAL BLOCK PROFILE

The Metal Block is available in 12 in (305 mm) x 1 in (25.4 mm) x custom length according to plans and specifications up to 60 ft (18.29 m). It's easy to create a unique design that lets your creativity run wild.



METAL BLOCK- 12 in (305 mm) x 1 in (25.4 mm) x custom length up to 60 ft (18.29 m)

WOOD OR STEEL FURRING

Depending on construction standards in your region, wood or steel furring may be required. This guide shows you how to install MAC cladding on wood furring. However, if your region's standards do not require it, it's up to you to decide whether or not to install it. In this case, installation can be carried out directly on the recommended rigid surface covered with a weather barrier.

CREATING AN INSTALLATION TEMPLATE

Prior to installation, we recommend that you calculate the width of the wall where you'll be installing the panels, so that you can create an installation template, if you haven't already done so, based on the size of the panels, and determine which sections will require cut panels.

3. PREPARATION

Before beginning the first step, make sure that the surface you wish to cover with Versa & Metal Block profiles meets all industry standards in effect in your region.

Check with local building authorities regarding the installation of metal or wood furring. If they are not required, it's up to you whether or not to install them.

MAC also recommends that you install a self-adhesive SOPRA Fil Stick VP membrane from Soprema self-adhesive membrane, and rely on the building code for your region.

We also recommend that you follow the building code for your province.

4. INSTALLATION & RECOMMANDATIONS

Before installing the panels, make sure your walls are level.

ORIENTATION

The Versa & Metal Block panels may be installed horizontally, vertically, or diagonally on vertical, horizontal, and diagonal furs.

SEALANT

We recommend applying a fine line of MAC sealant starting from the 4th floor of any building exposed to severe weather or from the 2nd floor of a building located in risk areas.

In the case of a new wood building with more than one storey, it will be necessary to provide a transition molding on each floor; on a steel structure, install a transition molding every 30 ft. In the case of a very long wall, it is recommended to install a vertical transition molding every 30 ft.

*Ensure immediate clean-up of excess sealant before it dries.

4. INSTALLATION

4.1 STARTING STRIP

Before beginning the first step, ensure that the construction of the surface to be covered with Versa/Metal Block siding complies with all current industry standards.

Please check with your local authorities regarding the installation of metal or wood furring. If they are not needed, then it's okay not to install them.



Install the starter strip, M10G, 3 1/2" above the point where your wall will be starting from. When specified or if necessary, install a drip molding beforehand. As needed, use MAC 1 1/2" flathead metal screws or MAC 1 1/8" flathead wood screws. You may now secure the first row with a first screw. When you are satisfied with the alignment, screw it into place.

** Make sure that the first row is level because it serves as your guide for the rest of the installation.

VERTICAL INSTALLATION

It is important to install a drip molding, M50G, at the bottom of the wall. No starter strip is necessary in that case.



4.2 STRENGTHENING THE PANELS

Strengthening the panels is mandatory only with 24 and 26-calibre panels, and optional with the 22-calibre panels.

Before starting the panel installation, you will need to do a reinforcement ply with the MAC folding tool for Versa & Metal Block Profiles at the end of each plank. Make sure not to curve your planks.

1.

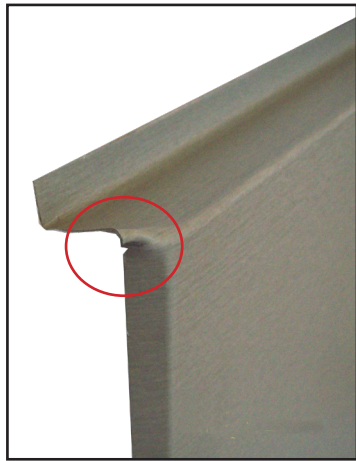

Cutting in the encircled areas

2.

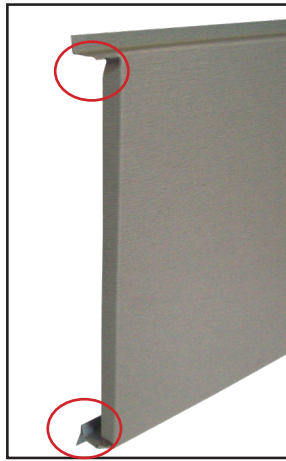

3.

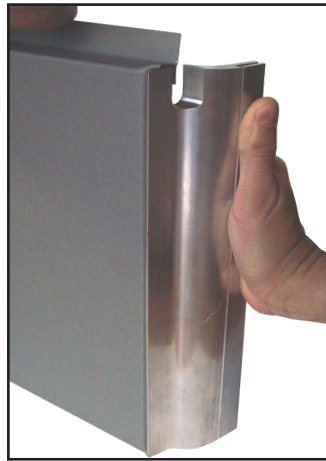

90° bending

4.3 PLASTIC FILM

If possible, remove the plastic wrap BEFORE installing the panel.

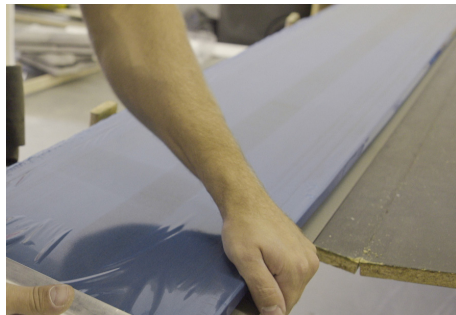

4.4 SCREWS

Drive the screws every 16 to 48 inches with moderate pressure on the metal. The screws should not exert pressure on the top or the bottom; otherwise, there may be deformation on the panel and/or joint spacing.



K-LATCH MAC Self
Drilling screw A053.250



K-LATCH MAC
Wood Screw A058.250



4.5 CUTTING

If you need to cut the panels, use the specialized MAC Guillotine especially designed for Versa or Metal Block siding, recommended by MAC Metal Architectural. You can also use, if needed, a snip or a shear.

*The use of an electric saw or an electric grinder is not recommended or covered by MAC Metal Architectural warranty.

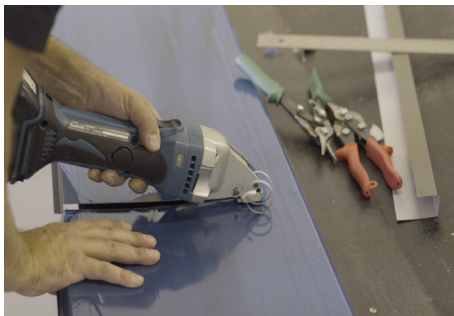

5. INSIDE CORNER

5.1 L CORNER

Place a metal L corner or an elastomeric self-adhesive membrane directly on the weather blocker or on the furring.



5.2 HORIZONTAL INSTALLATION

Place the inside corner molding (M22G) under the metal L molding or the elastomeric membrane. Then continue with the installation of the coverings on the walls by carefully sliding the panels inside the molding while leaving a 1/8 in space.

5.3 VERTICAL INSTALLATION

It is important to install an M50G drip moulding at the bottom of the wall. No starter strip is required.



6. OUTSIDE CORNER

MAC offers two options for outside corner moldings, namely moldings M20G or M21G.

The outside corner moulding (M21G) is installed exactly like the inside corner moulding but with an inverted fold. Refer to Step 5.2.

Moulding (M20G) is installed in two easy steps.

6.1 SECURING STRIP

After installing the panels on the two walls to form a corner, install the securing strip with screws.



6.2 FINISHING MOULDING

Apply MAC sealant (1 in L x ¼ in H) inside the finishing moulding before stapling it into place.

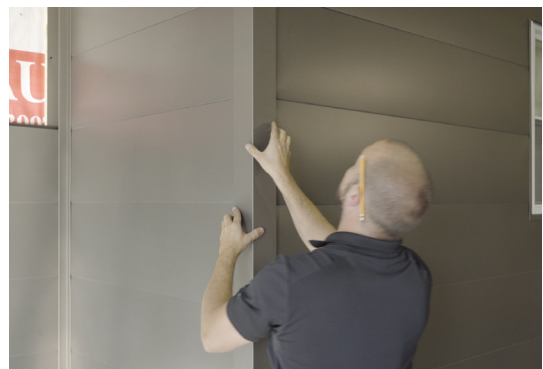

*If you do not have a base, you will need to install the corner with a screw. Cut and fold back the bottom of the finishing molding so that you have an anchoring surface.



7. WINDOW FRAMING

7.1 J Trim

When the wall you are covering has a window, you first need to install the standard J Trim M50G on both sides and the bottom of the window. Then, install a drip cap above the window frame.



7.2 ADJUSTMENTS

1. Measure and adjust the panel as needed before installing it.
2. In case the panel need some adjustment, cut it to the necessary height.
3. Install the cut panel backwards in order to give it more strength.



7.3 SIDES

Continue with the installation of the panels on each side of the window.



7.4 TOP OF THE WINDOW

We recommend installing a drip cap prior to putting the window's top plank into place.

In the case where the plank does not reach the full height, cut the plank with an extra $\frac{1}{2}$ in to create a 180-degree fold. Then, install the cut panel backwards in order to provide more support. Then staple the folded panel into the cut one.



8. WALL FINITION

8.1 ADJUSTMENTS

Measure the last panel in case the panel does not reach the full height and adjust it with electric shears. Install the trim panel backwards to give additional support to the cut panel.



8.2 J TRIM (SOFFIT)

Install the J Trim for soffit at the top of the wall. Then slide the soffit in place and screw it.





For more information on installing our Versa & Metal Block profiles, visit the PRO Space section of our website MACmetalarchitectural.com, or visit our YouTube channel.

Here you'll find a wealth of technical information on our profiles, including a series of installation videos, moulding booklets and access to technical drawings

MAC
METAL ARCHITECTURAL

MAC Metal Architectural
5975 Ch. de la Savane,
Saint-Hubert, QC J3Y 0X1
T. 450 464-5486 | T F. 450 464-4538
info@MACmetalarchitectural.com
MACmetalarchitectural.com