

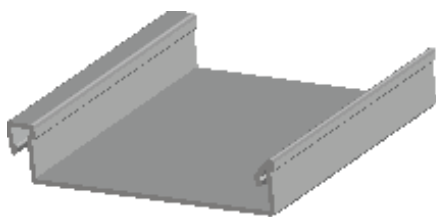

## UNDERHUNG CANOPIES

# QWIKLOK™

QwikLok™ is ideal for underhung applications. No more fighting with trying to install two panels at one time. Unlike conventional roofing cover, QwikLok™ can be assembled from the underside of the structure one panel at a time, producing a flush appearance with no exposed fasteners.



### Features and Benefits:

- QwikLok™ provides the basic design element for any type of canopy cover. Easy-to-trim flush surfaces make transitions to conventional material simple without major concern for creating special conditions. Direct the flow of water to any desired drainage point by combining QwikLok™ with the MBCI fascia/gutter. Canopies, walkway covers and soffits are all in the QwikLok™ design arena. High gloss finish, immense water carrying capacity and long span characteristics make QwikLok™ today's most popular choice for any underside application.
- The QwikLok™ panel is attached to the structure with the MBCI one-step fastened method. One-step fastened requires only one side of the panel to be attached to the structure. The adjoining panel is snap-locked to the first panel, concealing the fastener from view and providing a secure, flush appearance. This proven fastened method creates a positive interlock between panels. Install QwikLok™ over a variety of substructures such as light gauge framing, purlins, structural steel and joists.

### Product Specifications

- **Applications:** Roof
- **Coverage Widths:** 12"
- **Panel Attachment:** Concealed Fastening System
- **Gauges:** 24
- **Finishes:** Smooth (standard); Embossed (optional)
- **Coatings:** High Gloss White