

12

12

1/4-14 x 7/8 LAPTEK W/WASHER
[FASTENER #4A] (3) PER CLOSURE
(9) PER PANEL TOTAL

URETHANE TUBE SEALANT EACH END
@ UPSLOPE SIDE OF CLOSURE
TO FILL VOIDS AS NECESSARY

1/4-14 x 7/8 LONG-LIFE LAPTEK
W/WASHER [FASTENER #4] @ 6" O.C.

LS-36™ INSULATED ROOF
PANEL

RIDGE TRIM [F3445]

OUTSIDE CLOSURE [HW4041]
(3) PER PANEL W/
1" x 1/8" TAPE SEALER
[7300] ON TOP, BOTTOM,
& BOTH SIDES OF CLOSURE

THROUGH PANEL FASTENER
TYPE-B 304 SS W/ 1" O.D.
WASHER @ 12" O.C.

1" 2"

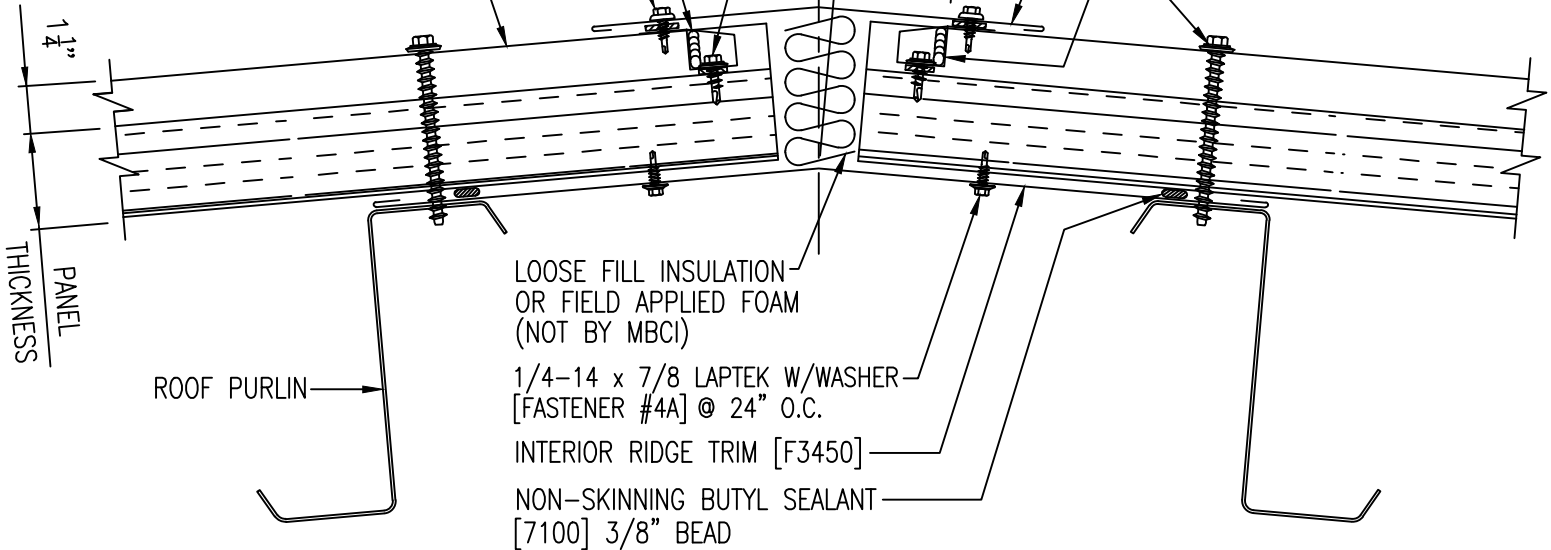

PANEL
THICKNESS

ROOF PURLIN

LOOSE FILL INSULATION
OR FIELD APPLIED FOAM
(NOT BY MBCI)

1/4-14 x 7/8 LAPTEK W/WASHER
[FASTENER #4A] @ 24" O.C.

INTERIOR RIDGE TRIM [F3450]

NON-SKINNING BUTYL SEALANT
[7100] 3/8" BEAD