

Horizontal Insulated CF Wall Panel Jamb With Standard Trim

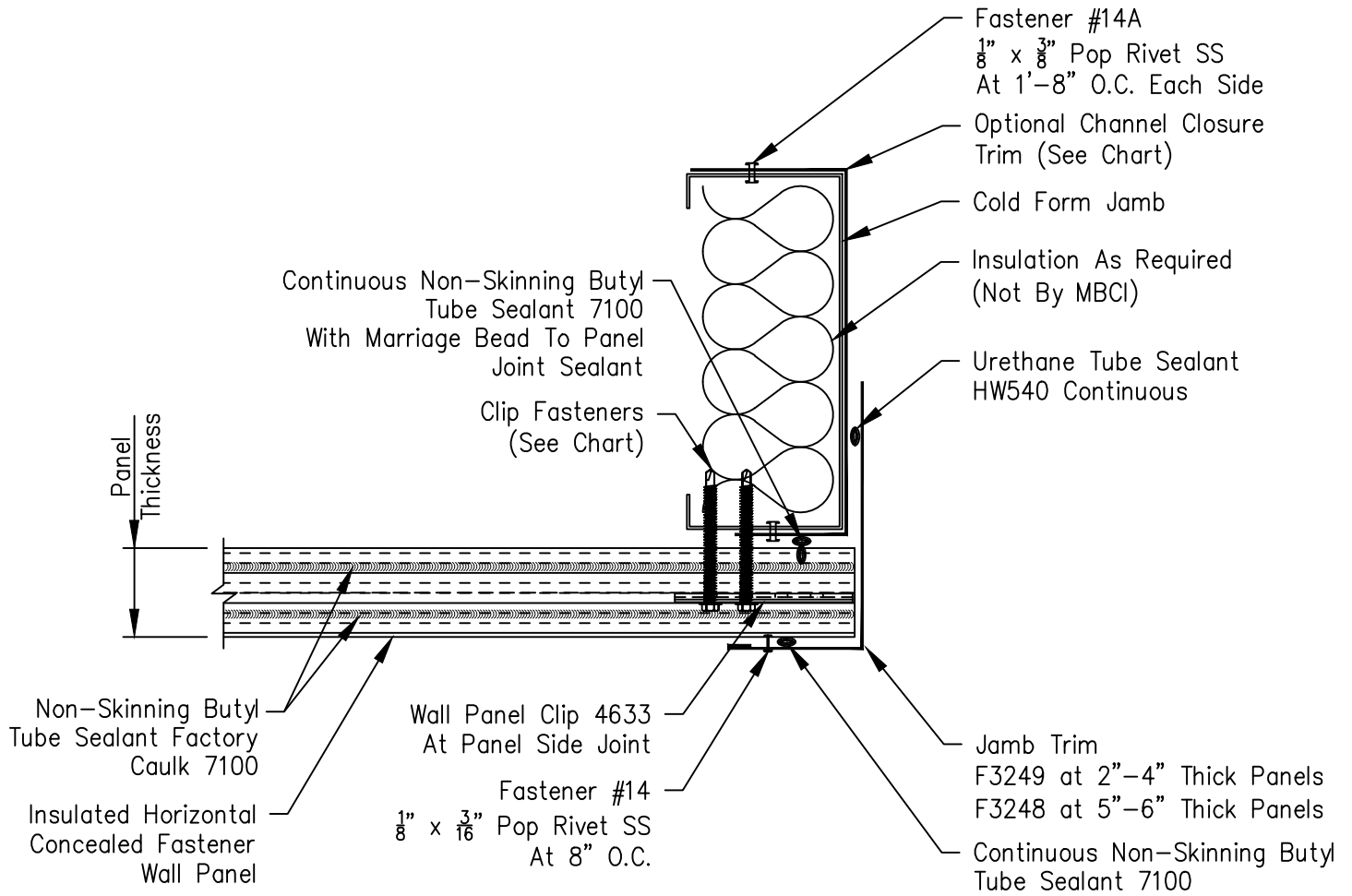

Installer Note:
The interior leg of the Installed
Channel Closure Trim is to be
oriented ($\pm 1/8"$) to match the interior
leg of the Header or Jamb.

Wall Panel Thickness	Clip Fastener
2"	#1616
2 1/2"	#1624
3"	#1624
4"	#1632
5"	#1640
6"	#1648

Member Size	Channel Closure
8"	F981
10"	F982
12"	F169