

# Horizontal Insulated CF Wall Panel Head With Standard Trim

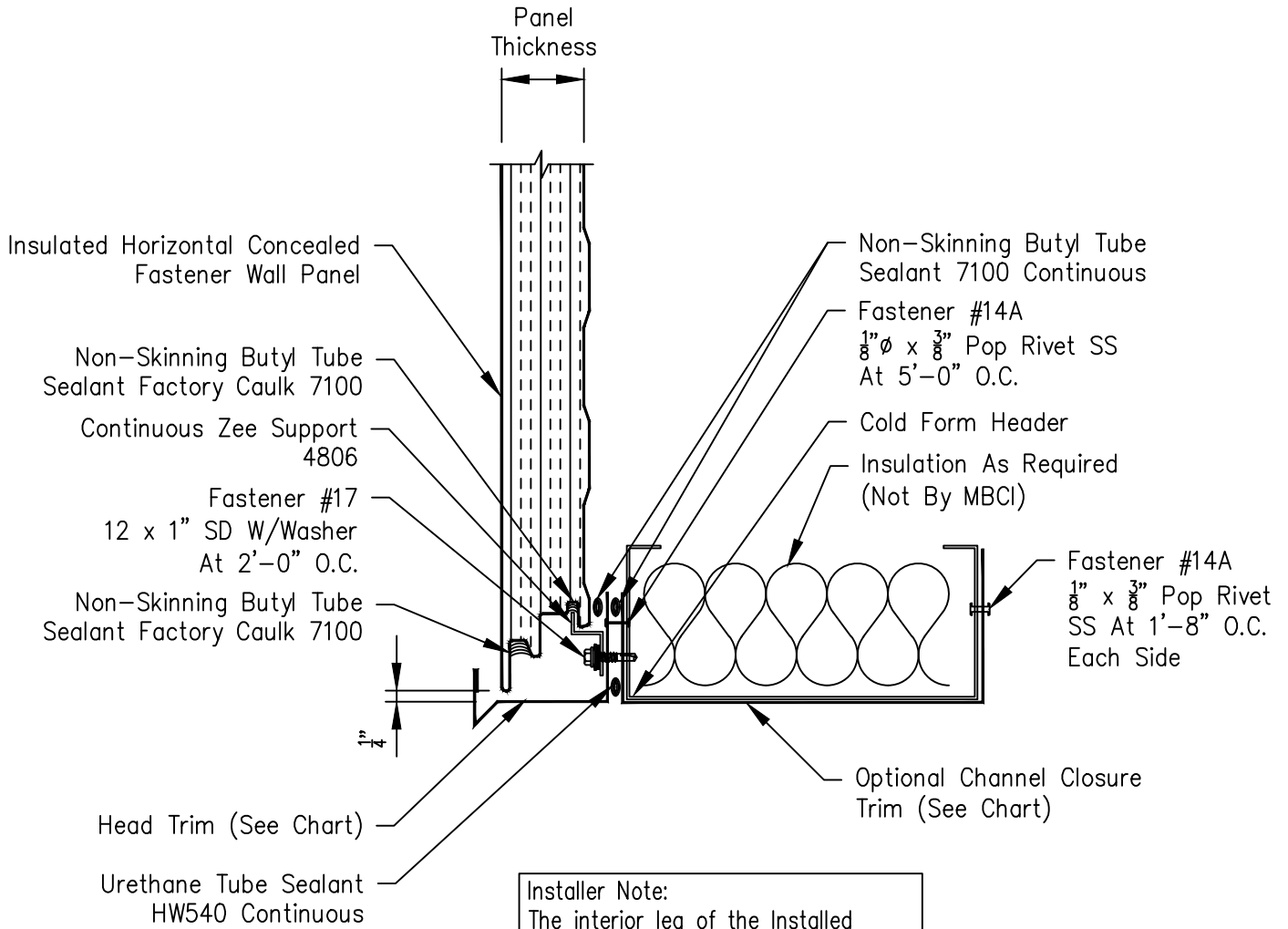

**Installer Note:**  
The interior leg of the Installed Channel Closure Trim is to be oriented ( $\pm \frac{1}{8}$ " ) to match the interior leg of the Header or Jamb.

Panel Thickness	Head Trim
2"	F3240
2½"	F3241
3"	F3242
4"	F3243
5"	F3245
6"	F3246

Member Size	Channel Closure
8"	F981
10"	F982
12"	F169