

COMMUNITY



MBCI Metal Wall and Roof Panels: The Solution for Community Service Projects

The public sector is a vital supply of demand for community and municipal construction services with an estimated two-thirds of annual capital investment in the commercial construction market. As municipal and state government funding increases so does demand for industry services.

MBCI's high-quality metal building products are an excellent choice for civic building applications such as fire departments, wastewater treatment facilities, housing authorities, federal government offices and other municipal structures.

From police stations to civic centers to courthouses, MBCI's metal wall and roof systems set the gold standard for government facility design with quick, economical installation to meet fast-track schedules. Also ideal for retrofitting existing structures to create a modern facades and meet building requirements when budgets do not allow for new construction.



MBCI WALL AND ROOF PANELS BENEFITS:

EXTRAORDINARY PERFORMANCE

MBCI's metal wall and roof panels effectively safeguard activity inside community service facilities by building barriers against harsh exterior elements. MBCI's metal panels come in a variety of finishes and offer a complete product portfolio for trim, structural and accessories to achieve a high-performing building envelope.

STRUCTURAL SUSTAINABILITY

Modern building design and renovation requires sustainability and project performance remain at the forefront. Increasing energy efficiency while reducing maintenance and energy costs are key drivers for a building design's success. MBCI offers a variety of products conducive to sustainable building. From our Cool Roof coatings, our recyclable metal roof and wall panels and highly energy-efficient metal panels, we have a product designed to fit each building's performance.

ALLURING AESTHETICS

Governmental buildings are often some of the most identifiable facilities within their communities. MBCI's metal wall and roof panels come in an array of colors and texture to ensure your next project provides a facade that would reflect pride to any community.

Name: East Texas Food Bank
Location: Tyler, TX
Products: BattenLok® HS, Artisan®

Color(s): Slate Gray
Architect: Fitzpatrick Architects
Roofing Contractor: HGR General Contractors

FW-120

The FW-120 panel is a concealed fastener wall and liner panel that provides a flat appearance. FW-120 is commonly used for architectural, commercial, and industrial markets. The heavy gauge offering provides for large spanning capabilities, particularly in composite wall applications.

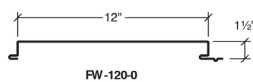

FW-120-0

Product Specifications

- **Applications:** Wall and Fascia
- **Coverage Widths:** 12"
- **Panel Attachment:** Concealed Fastening System
- **Gauges:** 24 (standard); 22 and 20 (optional)
- **Texture:** Smooth (standard); Embossed (optional)
- **Coatings:** Signature® 300

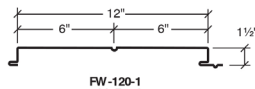

FW-120-1
with Bead

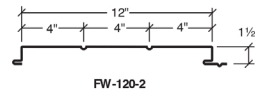

FW-120-2
with Beads

Features and Benefits

- FW-120 is available in a flat profile with no beads, one bead or two beads.
- The FW-120 Panel has been tested by a certified independent laboratory in accordance with ASTM® test procedures for Air Infiltration and Water Penetration at the sidelap. Test results show no air leakage at 1.57PSF and no water penetration at 6.24PSF differential pressure.
- FW-120 carries Florida approval rating.

CRAFTSMAN™ SERIES

The Craftsman Series is a snap-on batten roof system, available in narrow and high profiles: small (SB) and high batten (HB). The Craftsman Series is a water-shedding system and can be used for roofs and fascias only when installed over a water-proofed solid substructure with a minimum roof slope of 3:12. The Craftsman Series design makes complicated building transitions simple without the necessity of flashings. Slope changes from roof to fascia to soffit can be made with one continuous pan and batten.

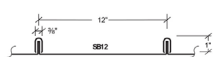
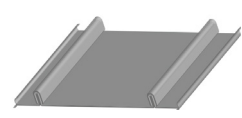

SB12

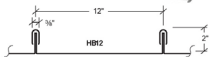
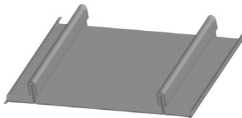

HB12

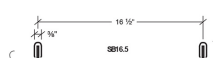

SB16.5



HB16.5

Small Batten (SB)

High Batten (HB)

Product Specifications

- **Applications:** Roof and Fascia
- **Coverage Widths:** 12", 16 1/2"
- **Minimum Slope:** 3:12
- **Panel Attachment:** Concealed Fastening System
- **Gauges:** 24 (standard); 26, 22 (optional)
- **Texture:** Smooth (standard); Embossed (optional)
- **Coatings:** Galvalume Plus®, Signature® 200, Signature® 300, Signature® 300 Metallic

Features and Benefits

- The pan and batten are manufactured separately to maximize design flexibility and for ease of installation at difficult hip, valley and slope change conditions.
- A concealed clip securely locks the batten to the panel while allowing for expansion and contraction.
- UL 580 rating is available, as well as UL 790, Class A for external fire, roof assembly for UL 263 for internal fire and the UL 2218 Class 4 impact rating.
- Craftsman Series carries Florida and Dade County approval rating.

BATTENLOK® HS

BattenLok HS is a mechanically field seamed, high strength structural standing seam roof system. The panels have a 2" tall vertical seam and are available in both 12-inch and 16-inch widths. BattenLok HS can be installed directly over purlins or bar joists, is capable of transitioning from roof to fascia and does not require a solid substructure for support.

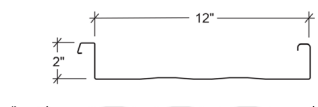
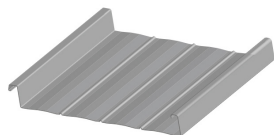

With Striations

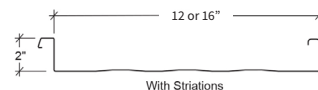

With Striations

Product Specifications

- **Applications:** Roof
- **Coverage Widths:** 12", 16"
- **Minimum Slope:** 1/2:12
- **Panel Attachment:** Concealed Fastening System; Low, High (fixed or floating), Utility (no insulation clearance)
- **Gauges:** 24 (standard); 22 (optional)
- **Texture:** Smooth or Embossed; with Striations or Striations and Pencil Ribs
- **Coatings:** Galvalume Plus®, Signature® 200, Signature® 300, Signature® 300 Metallic

Features and Benefits

- Low and high clips are available to allow for various thicknesses of insulation to be installed between the panels and purlins.
- Heavier gauges, striations, embossing and installation over a solid deck minimize oil canning.
- UL 580 rating is available, as well as UL 790, Class A for external fire, roof assembly for UL 263 for internal fire and the UL 2218 Class 4 impact rating.
- BattenLok Series carries Florida approval rating.

For more information on how MBCI metal wall and roof systems can impact your next community project, visit mbc.com/industries.



877-713-6224 | mbc.com | shop.mbc.com

Since 1976, MBCI has partnered with our customers to deliver high-quality metal building components backed by meaningful relationships and trusted performance. With our comprehensive portfolio and end-to-end expertise in building solutions, MBCI supports our customers throughout the project life cycle.

MAR_CMN - NJ 4/21