

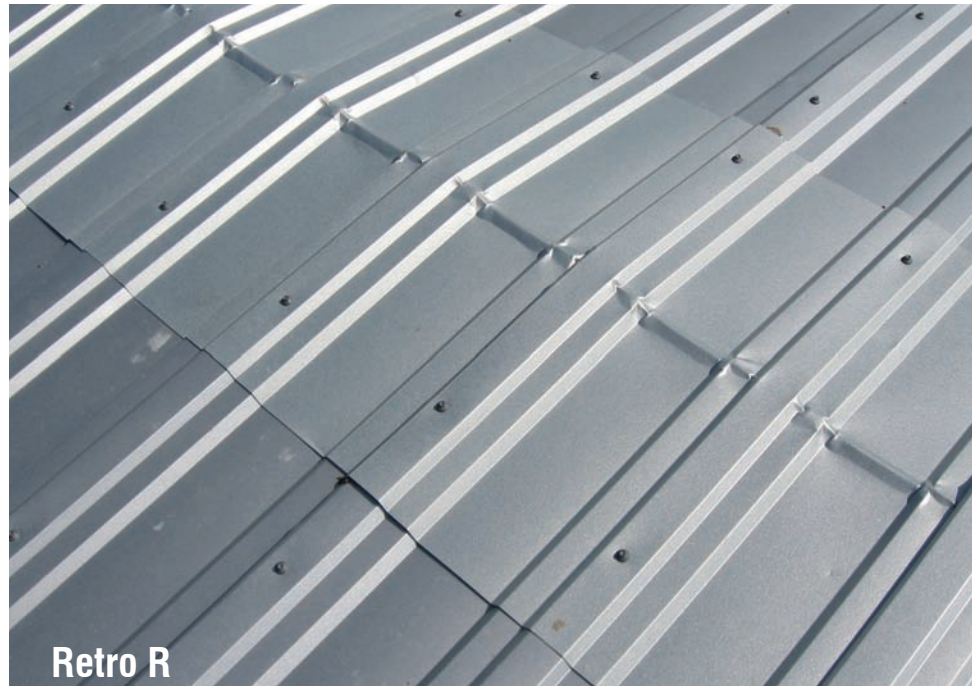

Double-Lok®



Retro R

Your Retrofit Solution PROVIDER

Introducing Two Low-Cost Simple Solutions to Retrofit an Existing R-Panel Roof

Is your existing R-panel roof in need of replacement or repair? MBCI offers two low-cost retrofit solutions to renew your existing roof.

Both of these reroofing options allow the existing roof to stay in place, which saves on labor costs while minimizing the chance for water entry into the building during the roofing process and providing for a safer working environment. Existing roof top equipment, vents or light transmitting panels can all be accommodated by either system. And, there's no interruption to business.

If you are looking to upgrade your roof to a standing seam, then installing our Double-Lok® roof panel over the existing roof without the need for sub-framing is an excellent choice. If you are looking for a low-cost solution and want to cover your roof with another through-fastened panel, then the Retro R panel installed over your existing roof is the right choice for you. Both systems are available in a wide variety of colors and offer long term warranties.



Double-Lok® Panel

OPTION 1: A New Standing Seam Roof

The first option for retrofitting over an existing R-panel roof is our Double-Lok® standing seam roof system. The 24" wide Double-Lok® roof panel is a mechanically field-seamed, trapezoidal leg standing seam roof system. Double-Lok® requires a minimum slope of ¼:12. The Double-Lok® roof system is UL-90 and FM rated. When choosing the Double-Lok® option, high clips are used to provide clearance between the Double-Lok® panel and the major ribs of the existing R-panel.

There are two options to increase the energy efficiency when using the Double-Lok® panel over an existing R-panel. The first is adding two-inch unfaced fiberglass insulation between the existing R-panel and the new Double-Lok® panel. The second is to vent the cavity between the old and new roofs by adding a vent strip at the eave to allow air intake and a vented ridge to provide for air exhaust. This method works well with roof slopes of 3:12 and greater.

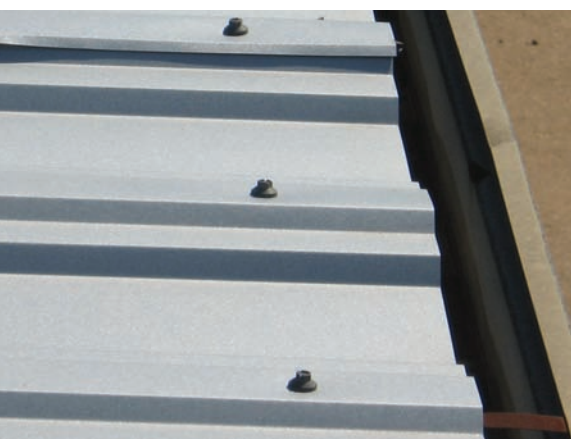

Retro R Panel

OPTION 2: Retro R Panel

The second option is using MBCI's Retro R panel over the existing R-panel. The Retro R panel has rib spacing 12" on center with a rib height of 1 1/16". The minimum slope for the Retro R panel is ½:12. The existing lap screws must be removed from the R-panel roof before the Retro R panels are installed. The screws that attach the existing R-panels to the purlins do not have to be removed. The Retro R panels are attached with special shoulder screws that fasten through the existing R-panel major ribs and into the existing purlins. Once the Retro R panels are installed, new lap screws are installed through the Retro R ribs and into the existing R-panel side laps.

Engineering Considerations

You should always consult with a registered professional engineer to properly design the retrofit roof. The following considerations should be addressed:

- Will the building accept the additional loads imposed upon it by the retrofit roof?
- Do the local codes have restrictions on this type of construction?
- Does the roof cavity need to be vented between the old and new roofs?
- Does the building need additional insulation in the roof?
- Is there equipment that will need to be temporarily removed and reinstalled on the new roof?

Retro R

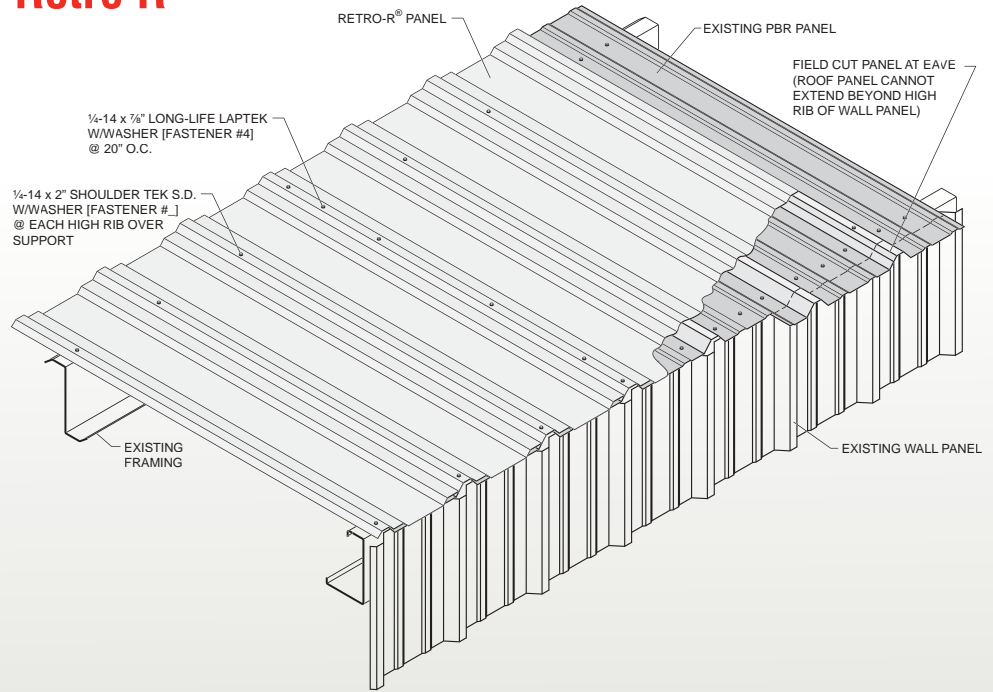

Double-Lok®

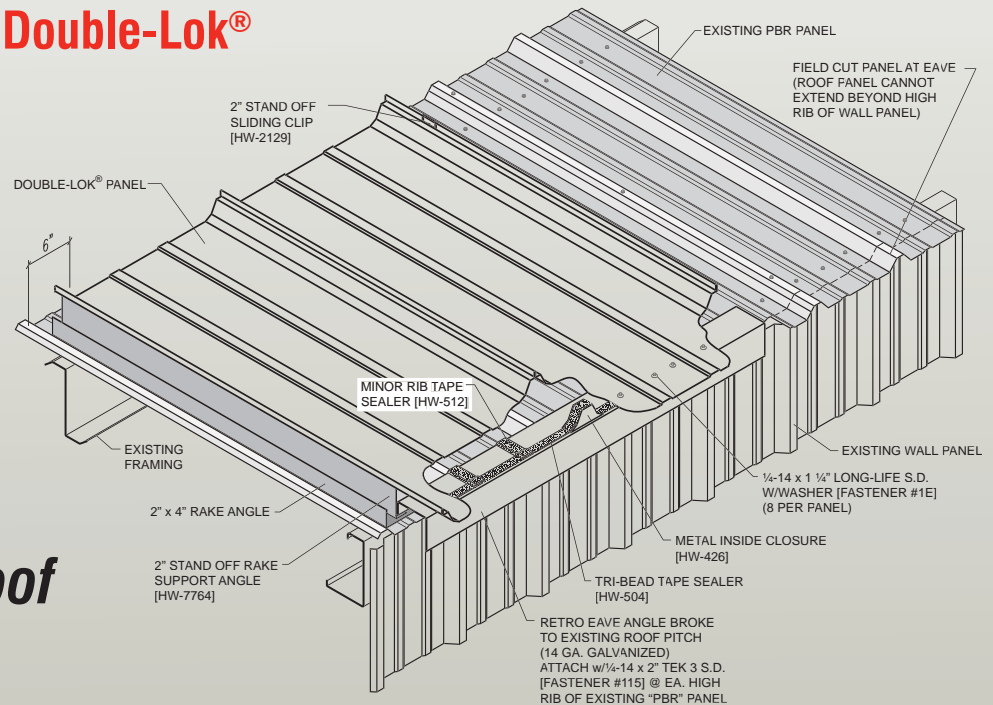

Low-Cost Simple Solutions to Retrofit an Existing R-Panel Roof

MBCI: The Name You Can Trust

Since 1976, MBCI has been providing metal construction solutions, including retrofit roof and wall solutions, to the industry. We understand your needs, which is why we continually strive to meet your demands. Look to MBCI as your retrofit roofing provider.

Descriptions and specifications contained herein were in effect at the time this publication was approved for printing. In a continuing effort to refine and improve products, MBCI reserves the right to discontinue products at any time or change specifications and/or designs without incurring obligation. To ensure you have the latest information available, please inquire or visit our website at www.mbc.com. Application details are for illustration purposes only and may not be appropriate for all environmental conditions, building designs or panel profiles. Projects should be designed to conform to applicable building codes, regulations and accepted industry practices. If there is a conflict between this manual and project erection drawings, the erection drawings will take precedence.

Double-Lok®

Double-Lok® Endlap

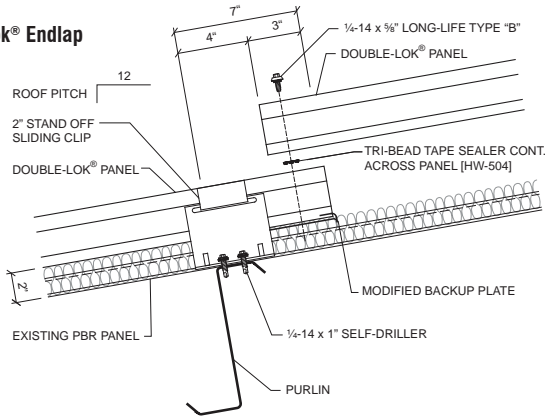

Double-Lok® Eave

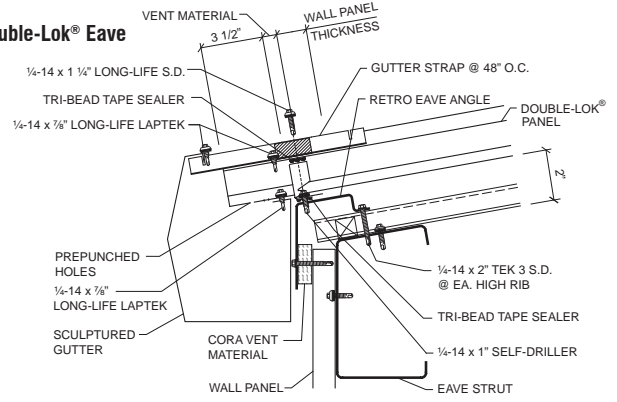

Double-Lok® Rake

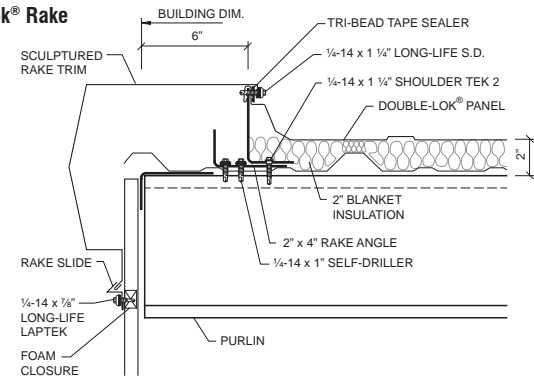

Double-Lok® Ridge

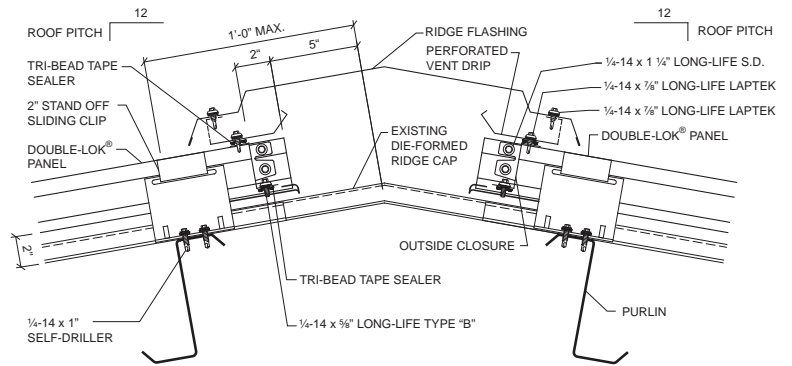

Retro R

Retro R Endlap

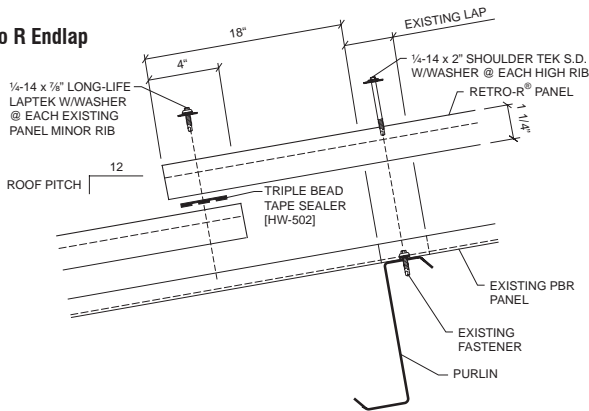

Retro R Eave

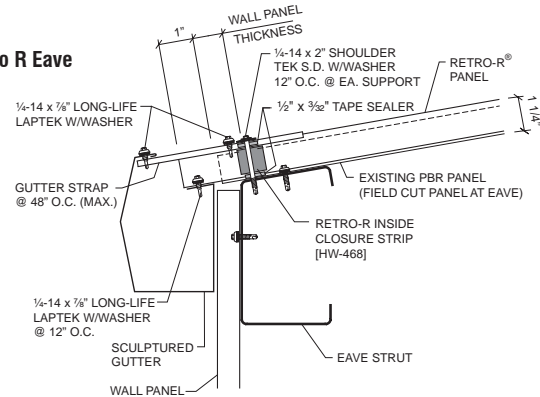

Retro R Rake

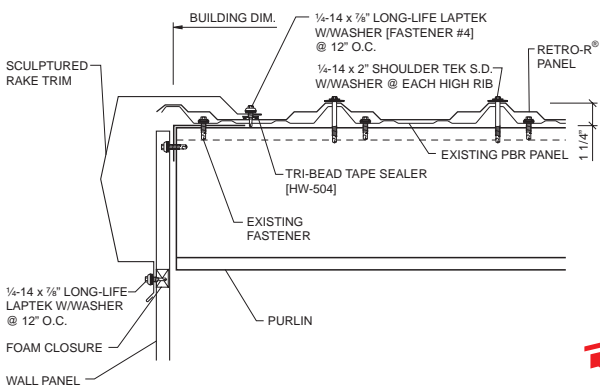

Retro R Ridge

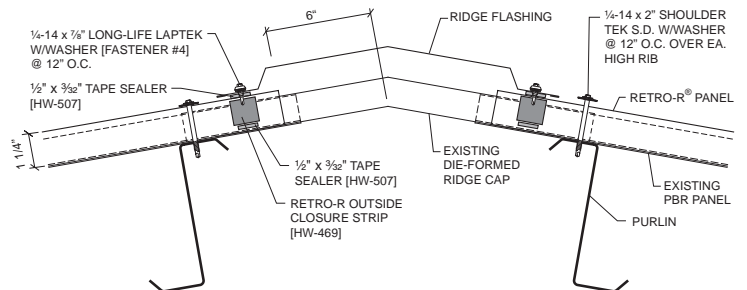

*See installation manuals for full details